

Creating An Environment For Successful Aging

FCOA
August 13, 2013

Why conduct an assessment?

- Service demand is increasing
- Support resources are decreasing
- Environment requires:
 - Current and projected demographics
 - Comprehensive analysis
 - Data driven planning
 - Targeted capacity-building
 - Coordinated service provision



How can an assessment help your community?

- Planning
- Identifying gaps
- Facilitating communication
- Creating partnerships
- Developing innovative services
- Increasing awareness/visibility
- Reducing duplication
- Bringing investment into the community



Community engagement in initial effort

- Stakeholder interest meeting
- Consensus building
- Determine level of participation
- Partner identification
- Formation of steering committee

Funding the project

- Identify research consultant
- Raise interest/awareness
- Grant opportunities
- Make the project real
- Identify and contact logical partners
- Investment and ownership – it all adds up!



"Before anything else, preparation is key to success."
Alexander Graham Bell

"The only place success comes before work is in the dictionary."
Vince Lombardi

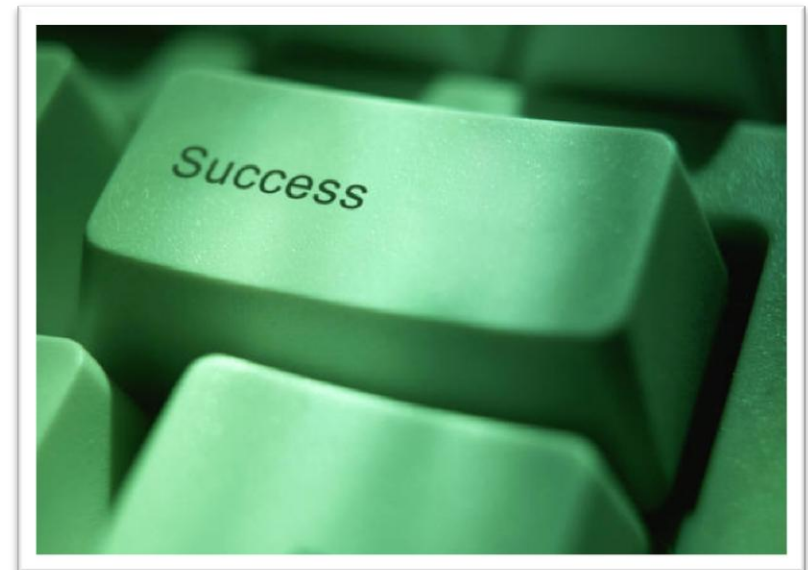

What does the community at large think?

Who lives in my community?

How healthy or sick are they?

What services do they have access to and use?

What do stakeholders think and want?

FOUNDATION

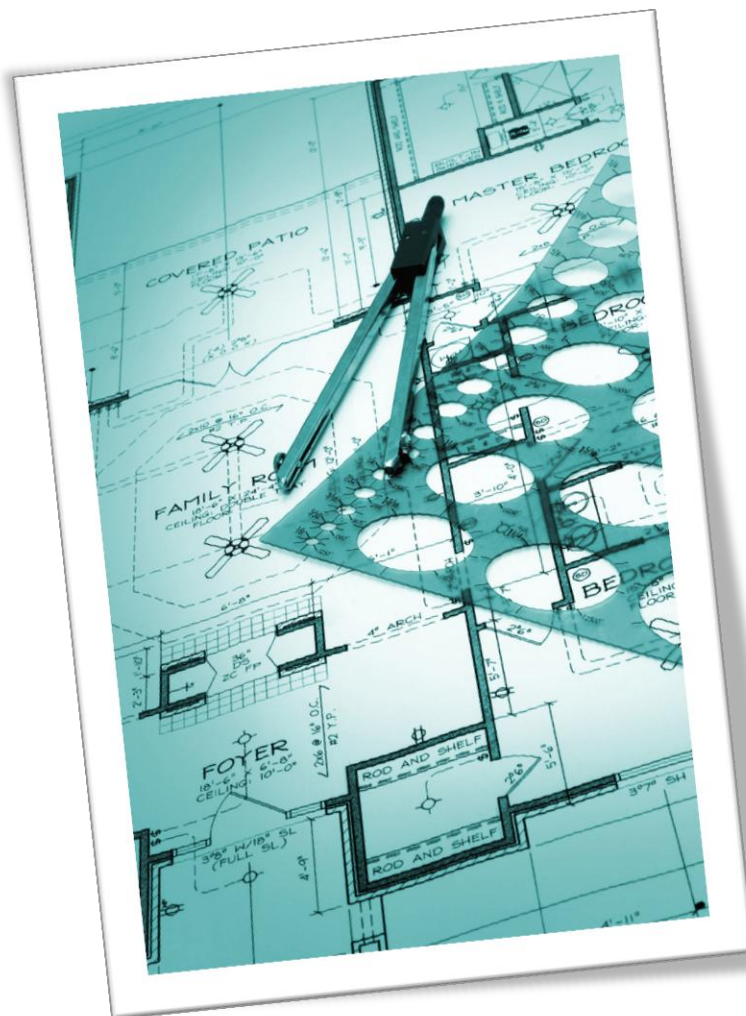

Population



- Number of people 50+
- Where they live
- Age ranges
- Projections
- Race
- Ethnicity
- Gender
- Veterans



Health

- Disability rates
- Diseases
- Medicare
- Medicaid eligible
- Medical providers
- Hospitalization
- Health ratings
- Average days sick
- Exercise
- Insurance

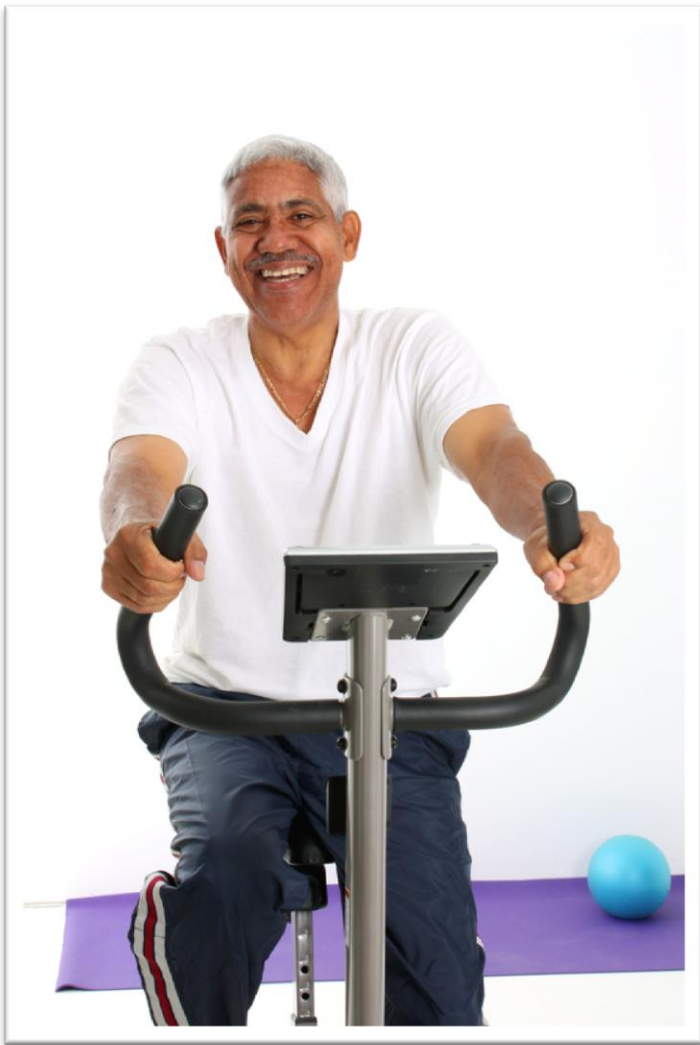

Financial status

- Median household income
- Employment/unemployment
- Poverty
- SNAP participation

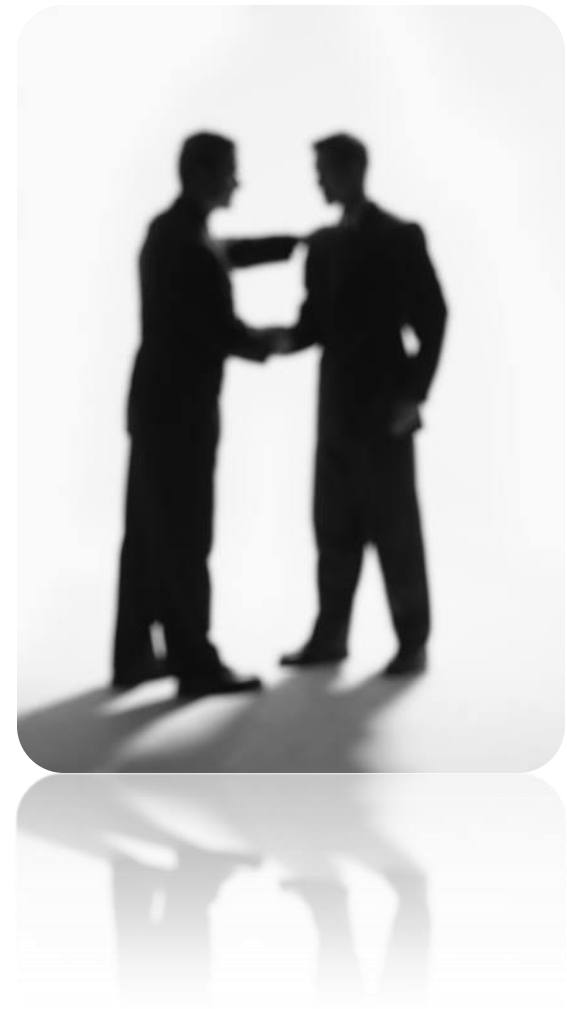

Home Ownership

- Expenses
- Living alone
- Homelessness



Safety and security

- Crime rates
- Emergency response



Transportation

- Driver's license
- Public transportation



Pulse of community

- Focus groups
- Telephone survey
- Stakeholder interviews



Answered:

- What the heck is a senior anyway?
- Are you lonely or isolated?
- See yourself being in poor, fair, or good health?
- Care for others?
- Have an adequate support system/financial resources?
- Need help with ADLs?
- Have issues with housing?
- Have a cost burdened home?
- Participate in activities?
- Have access to enough activities?
- Feel safe?
- Know about and use public transportation?
- Aware of services?
- Know how to access services?



Post-assessment progress

- Identifying priorities
- Convening community service providers
- Asset identification and mapping
- Action plan development





Contact Us

Barbara Allan

CEO

SRA Research Group, Inc.

8140 SE Federal Highway

Hobe Sound, FL 33455

(561) 744-5662

ballan@sra-researchgroup.com

www.sra-researchgroup.com

Ginna O'Connor

Vice President of Programs

Senior Resource Association

694 14th Street

Vero Beach, FL 32960

(772) 469-2068

oconnorg@sramail.org

www.seniorresourceassociation.org